

FREEHOLD



House - Semi-Detached (EPC Rating: C)

# 92 GLENVIEW CRESCENT, MOODIESBURN, GLASGOW, G69 0NL

Offers over

# £199,995

## FEATURES

- Semi-detached property
- Lounge
- Bright conservatory
- Enclosed rear garden
- 3 Bedrooms
- Dining room / Kitchen
- Family bathroom upstairs
- Garage and driveway



**SWEET  
HOME**



# 3 Bedroom House - Semi-Detached located in Glasgow

Caroline Morrison of Sweet Home Scotland is delighted to present this outstanding three-bedroom semi-detached apartment located on Glenview Crescent in the charming area of Moodiesburn, Glasgow. This property offers a perfect blend of comfort and modern living, making it an ideal choice for families or those seeking a spacious home.

Upon entering, you are welcomed into a bright and inviting hall that leads to a generous lounge and dining room, perfect for entertaining guests or enjoying family meals. The well-appointed kitchen is designed for practicality and ease, providing ample space for culinary creations. Adjacent to the Dining room, the conservatory offers a delightful space to relax and enjoy views of the garden throughout the seasons.

The upper level features three well-proportioned bedrooms, each providing a peaceful retreat for rest and relaxation. The family bathroom is conveniently located, ensuring that all amenities are easily accessible.

Outside, the property boasts an enclosed rear garden, ideal for children to play or for hosting summer barbecues. The garage provides additional storage or parking options, while the mono bloc

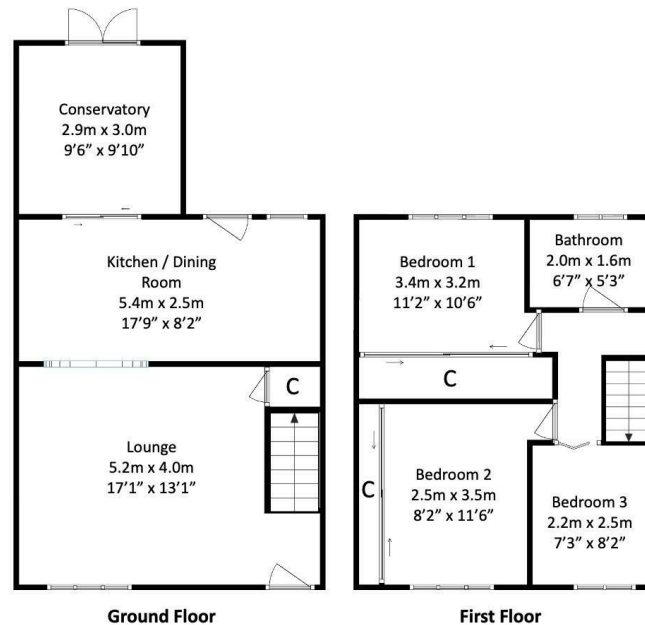

Call us on

**01236 677500**

[sales@sweet-home.co.uk](mailto:sales@sweet-home.co.uk)

<https://sweet-home.co.uk/>

**Council Tax Band**

**D**

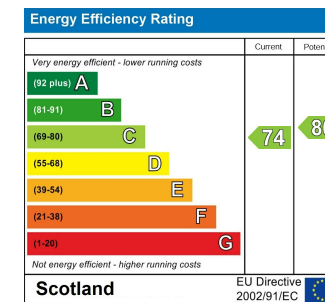

Agents Note: Whilst every care has been taken to prepare these particulars, they are for guidance purposes only. All measurements are approximate and are for general guidance purposes only and whilst every care has been taken to ensure their accuracy, they should not be relied upon and potential buyers are advised to recheck the measurements.

